

Built-In Closet Cabinet

Addicted2DIY.com

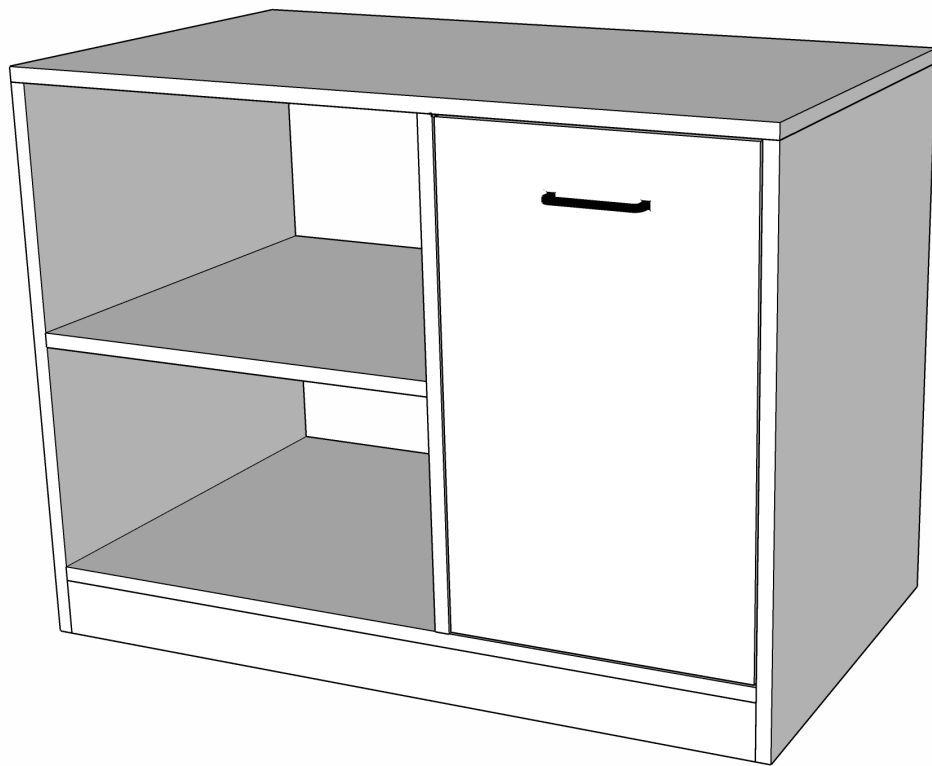

Before beginning this project...

Please read through all of the plans as well as the blog post associated with this project . Always use safety precautions whenever using power tools and follow the manufacturer's suggested guidelines. Make sure to wear proper safety protection (eye protection, hearing protection, etc.) before beginning any project. Cut all pieces per the measurements in the plans, unless noted otherwise. Builder assume risk and liability of any injury incurred as a result of building this project.

Materials and Cut List:

Materials Needed:

- 2 sheets - 3/4" veneer plywood
- 1 - primed plywood board @ 8' long
- 7/8" veneer edge banding
- 1 1/4" pocket screws
- Wood glue
- Wood filler
- Caulk
- Laundry Hamper to fit 13 1/4" wide drawer
- Paint or stain of choice
- 18" drawer slides
- Drawer pull of choice

Measure closet dimensions to determine proper depth and width of cabinet before cutting plywood pieces to size.

Cut List:

- 2 - 3/4" plywood @ 23 1/2" x 29 1/4" (cabinet sides)
- 1 - 3/4" plywood @ 38 3/4" x 23 1/2" (cabinet bottom)
- 1 - 3/4" plywood @ 23 1/2" x 40 1/4" (cabinet top)
- 1 - 3/4" plywood @ 23 1/2" x 25 1/2" (center divider)
- 1 - 3/4" plywood @ 17" x 84" (upper shelf of closet)
- 1 - 3/4" plywood @ 15 3/4" x 25 1/4" (drawer front)
- 2 - 3/4" plywood @ 18" x 13 3/4" (drawer sides)
- 1 - 3/4" plywood @ 6" x 13 1/4" (drawer back)
- 1 - 3/4" plywood @ 13 1/4" x 18" (drawer bottom)
- 2 - 3/4" plywood @ 3" x 38 3/4" (front and back aprons)
- 1 - 3/4" plywood @ 21 3/4" x 23 3/8" (adjustable shelf)

Step One:

Apply veneer banding

Using a hot clothes iron, apply veneer banding to all exposed edges of the plywood on all pieces. Trim the veneer banding with a trimming tool or razor knife. Sand all of the pieces smooth with an orbital sander and 220 grit sandpaper.

Step Two:

Build The Cabinet Carcass

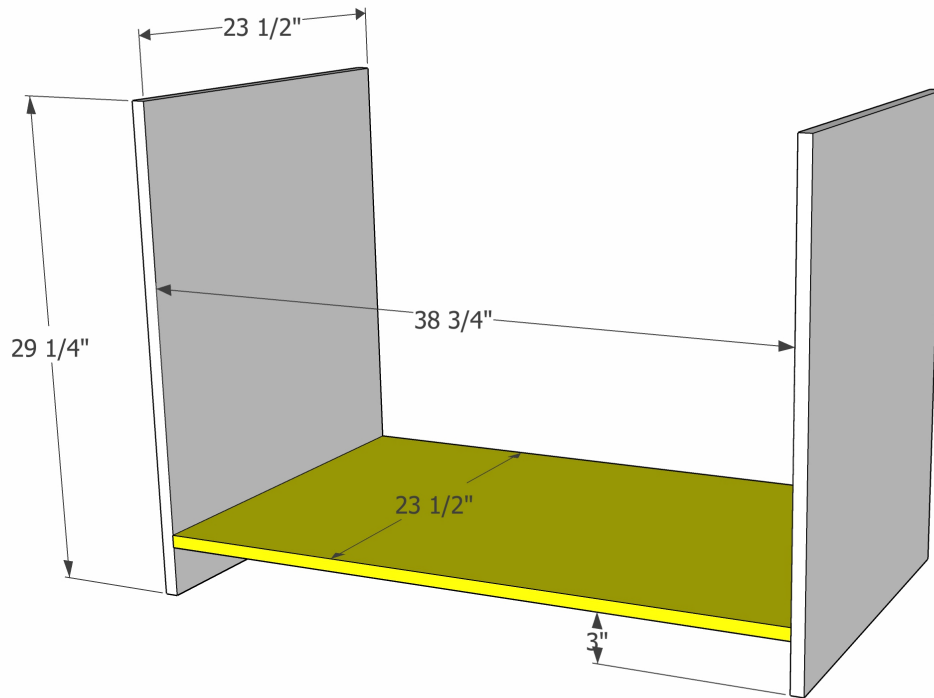

Drill 3/4" pocket holes into each end of the cabinet bottom. Also drill 3/4" pocket holes into the top edge of the cabinet sides. Mark 3" up on each of the cabinet side pieces. Place the cabinet bottom at the 3" mark. Attach with wood glue and 1 1/4" pocket screws.

Step Three:

Attach the top

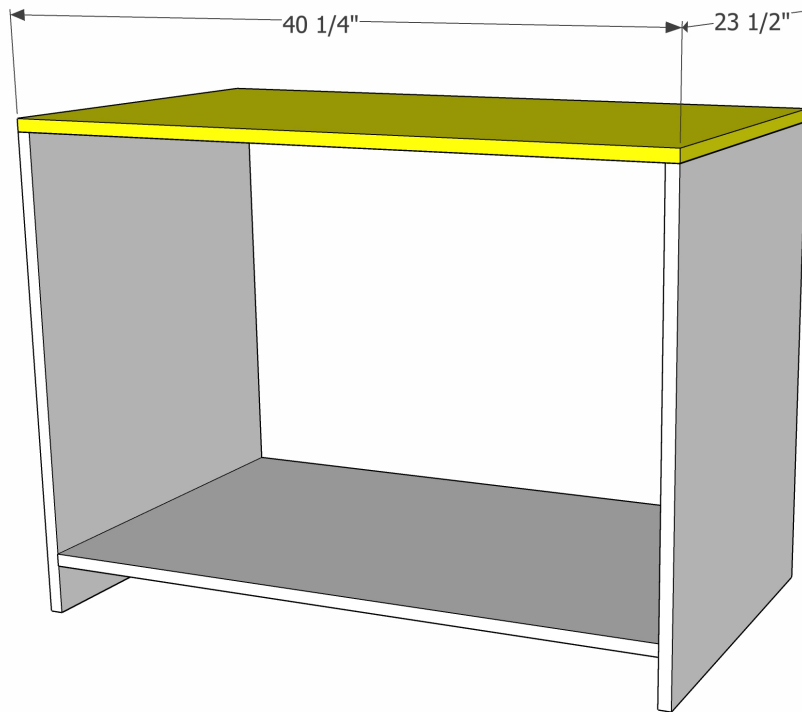

Attach the cabinet top using wood glue and $\frac{3}{4}"$ pocket screws. The ends of the top should be flush with the outside faces of the side panels.

Step Four:

Install The Center Divider

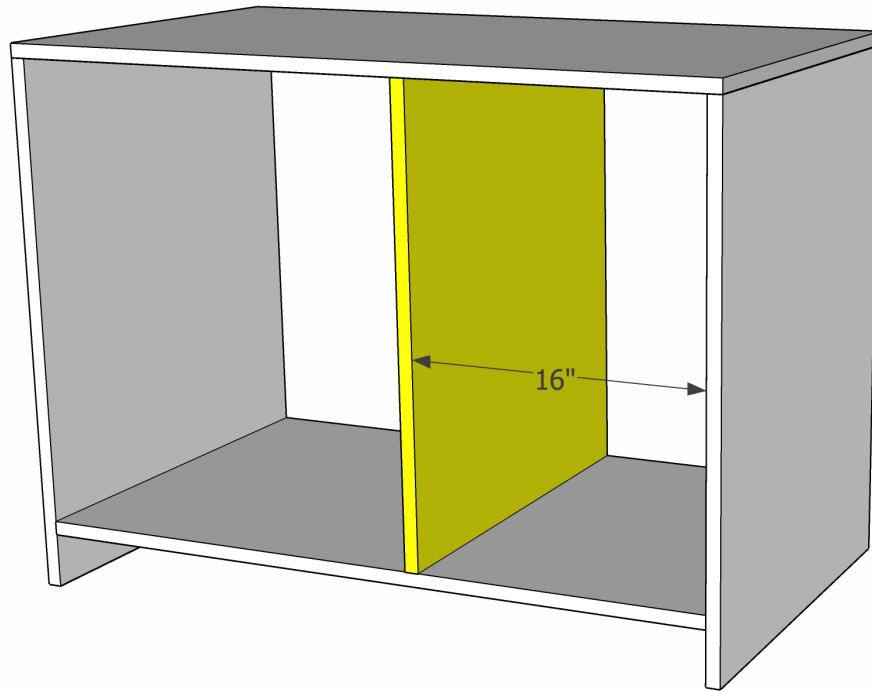

Drill 3/4" pocket holes into the top and bottom ends of the center divider. Mark 16" from one side (depending on which side you'd like the drawer), or cut a piece of scrap wood at 16" to act as a spacing block. Position the divider in place and attach with 1 1/4" pocket screws.

Step Five:

Attach The Front and Back Aprons

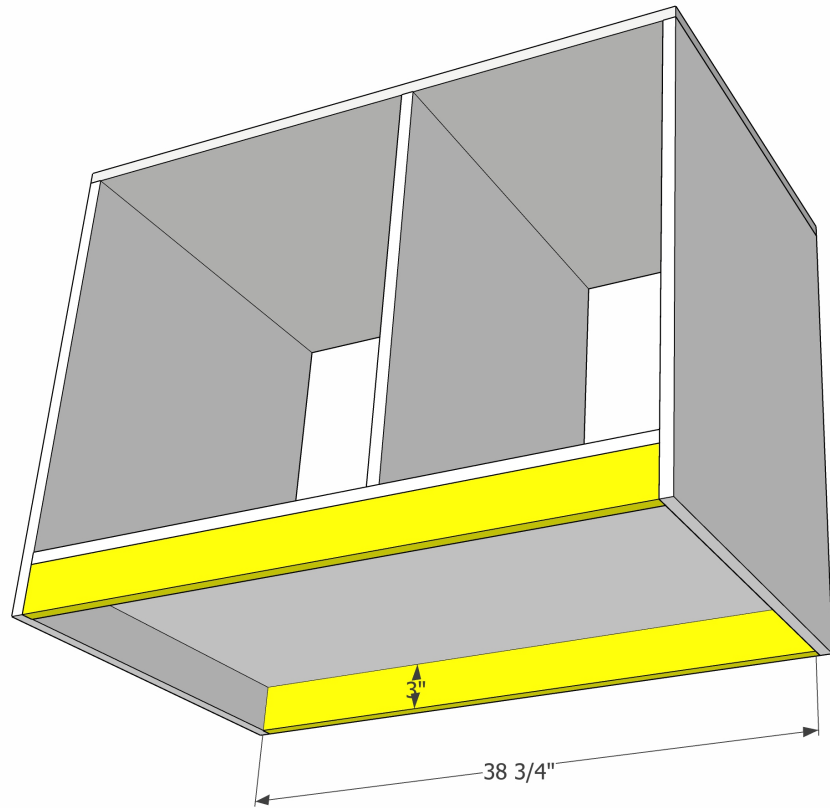

Drill 3/4" pocket holes into each end and one long side of the apron pieces. Attach to the bottom of the cabinet with wood glue and 1 1/4" pocket screws.

Step Six:

Drill Shelf Pin Holes

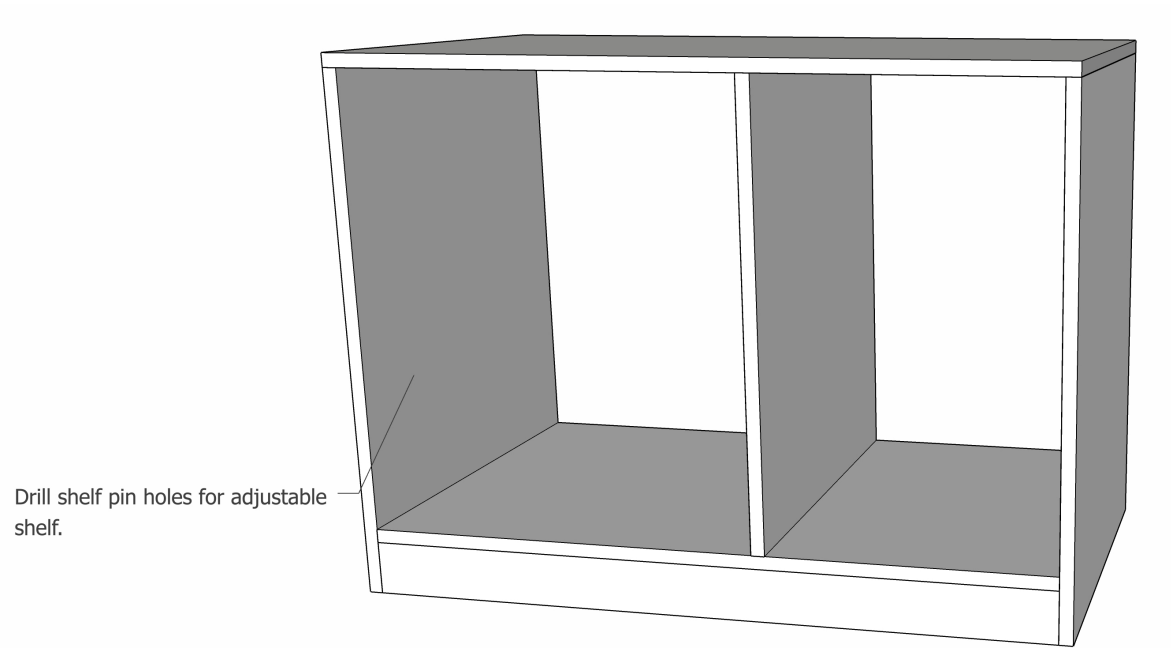

Using a shelf pin jig, drill the shelf pin holes on each side of the large opening for the adjustable shelf.

Step Seven:

Build The Drawer

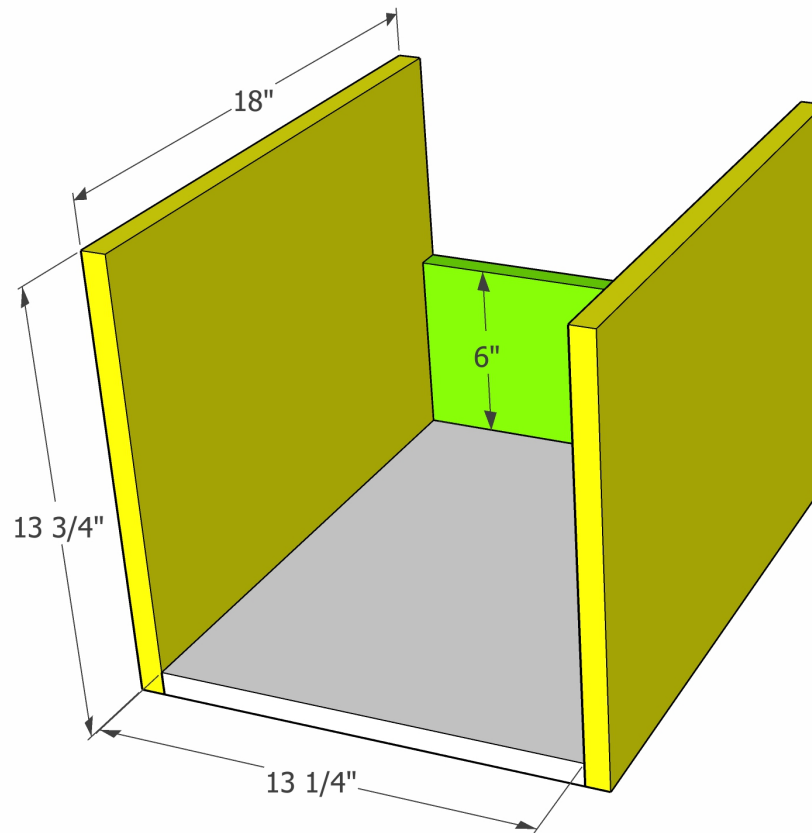

Drill 3/4" pocket holes into the front edge of the drawer sides, the front and sides of the drawer bottom, and the sides and bottom of the drawer back. Glue and attach the pieces together with 1 1/4" pocket screws.

Step Eight:

Attach The Drawer Front

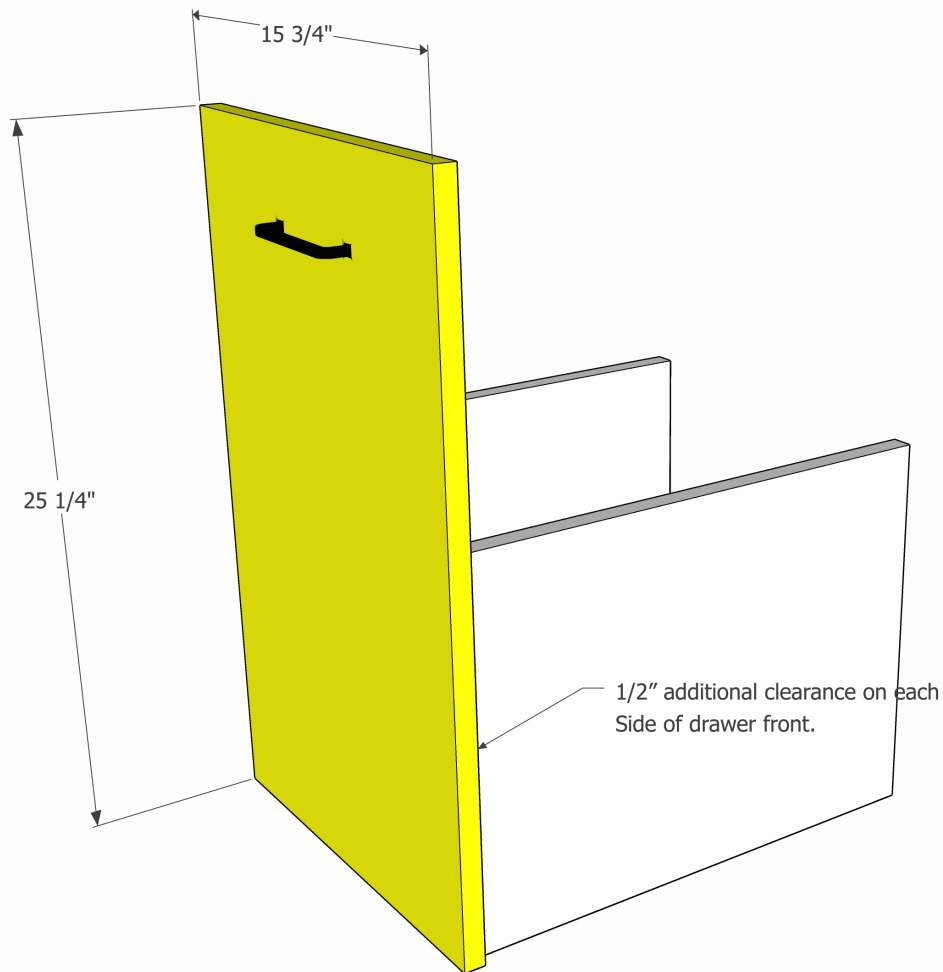

Attach the drawer front with a 1/2" overhang on each side, using wood glue and 1 1/4" pocket screws. Install the drawer pull.

Step Nine:

Cut The Adjustable Shelf

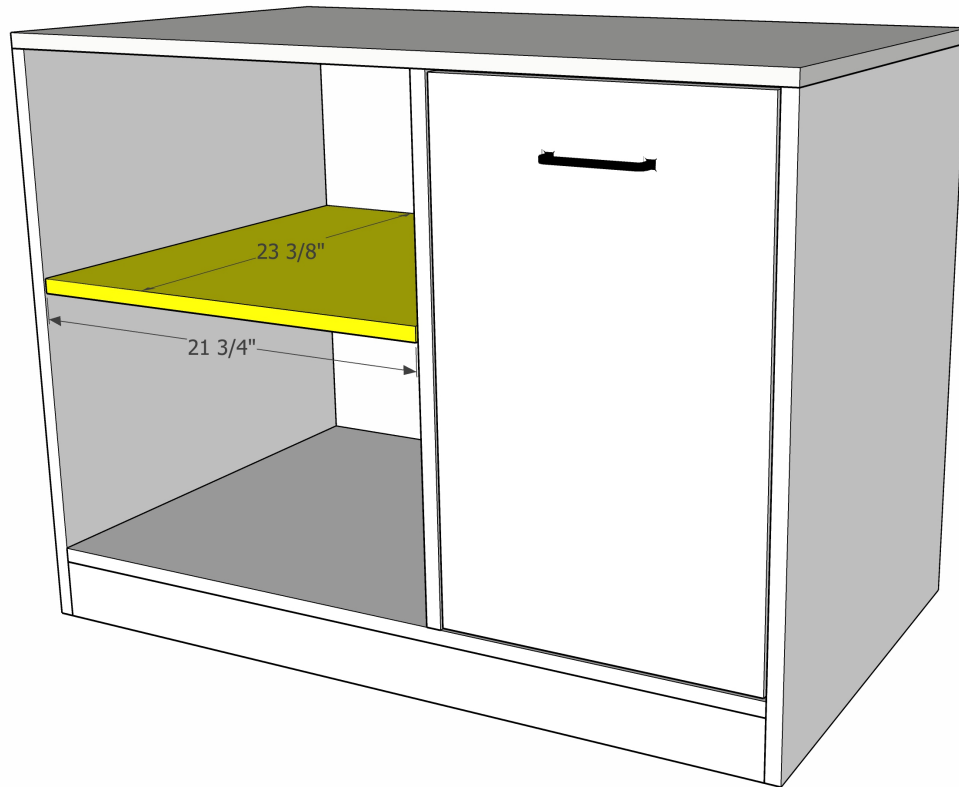

Finish the cabinet as desired with paint or stain. Install the drawer with 18" drawer slides. Install the adjustable shelf with shelf pins in coordinating color.

For the upper closet shelf (if installing), cut the primed plywood 1x3 pieces to size and install using $2 \frac{1}{2}"$ wood screws, driven into the studs in the wall. Caulk around all edges and seams to seal.

This project can be built exactly to the specs in the plans; however, all closet dimensions and layouts are different. Feel free to use these plans as a guide to help you build your own closet cabinet based on the closet dimensions in your own home.