

DIY Trestle Entry Table

Sawdust2Stitches.com and Addicted2DIY.com

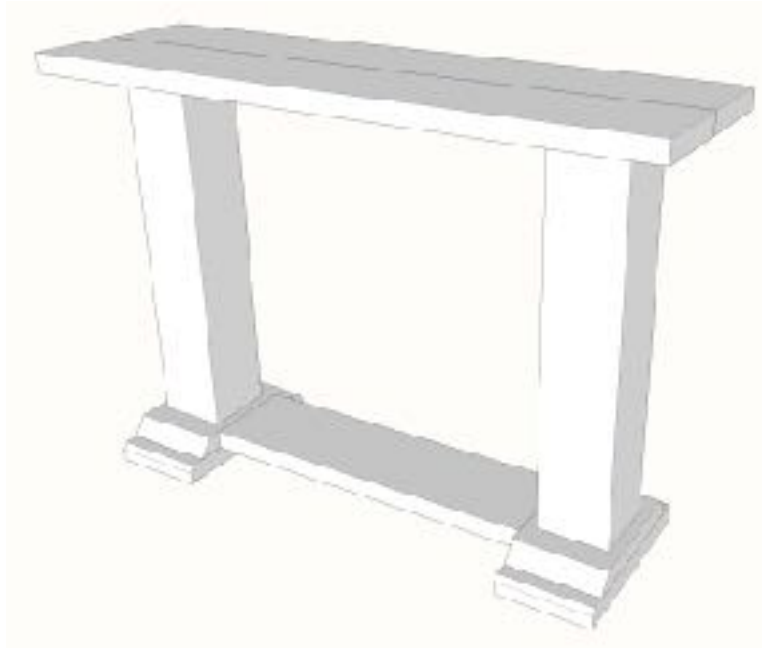

***Before beginning this project, please read through all of the plans as well as the blog post associated with this project . Always use safety precautions whenever using power tools and follow the manufacturer’s suggested guidelines. Make sure to wear proper safety protection (eye protection, hearing protection, etc.) before beginning any project. Cut all pieces per the measurements in the plans, unless noted otherwise.**

Tools and Materials List:

- 2 - 2x8 boards @ 8' long
- 3 - 1x6 boards @ 8' long
- 1 1/4" brad nails
- 2 1/2" pocket screws
- 2 1/2" wood screws
- Wood Glue
- Wood Filler
- 220 Grit Sandpaper
- Orbital Sander
- Drill/Impact Driver
- Miter Saw
- Table Saw
- Brad Nailer
- Kreg Jig

Cut List:

- 2 - 2x8 @ ~4' long (cut 1 board in half)
- 2 - 2x8 @ 14 1/4" long
- 2 - 2x8 @ 11 1/2" long
- 1 - 2x8 @ 27 1/2" long
- 8 - 1x6 @ 28 1/2" long

STEP 1:

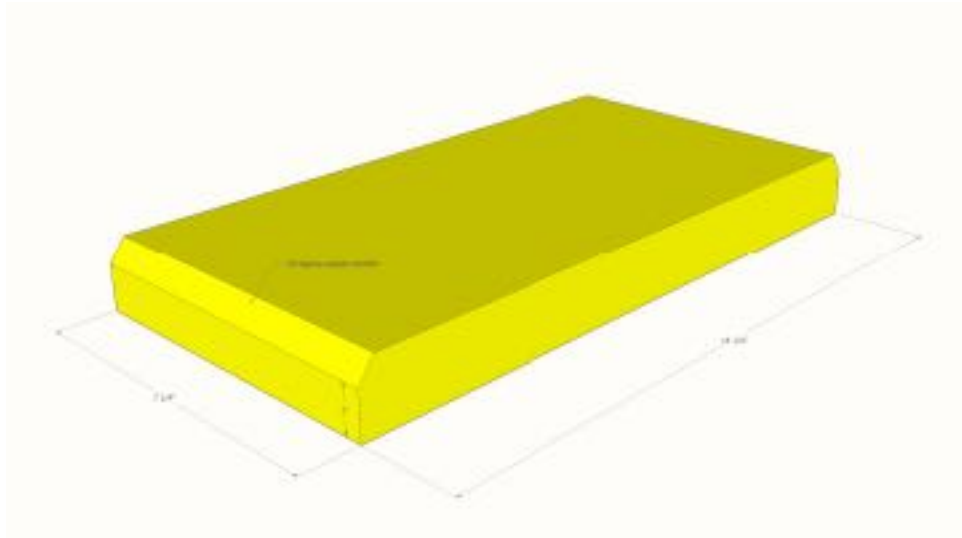

Begin by cutting the bottom pieces for the table base on your miter saw. Cut a 35 degree chamfer on the top edge of the front and back of the base (optional).

STEP 2:

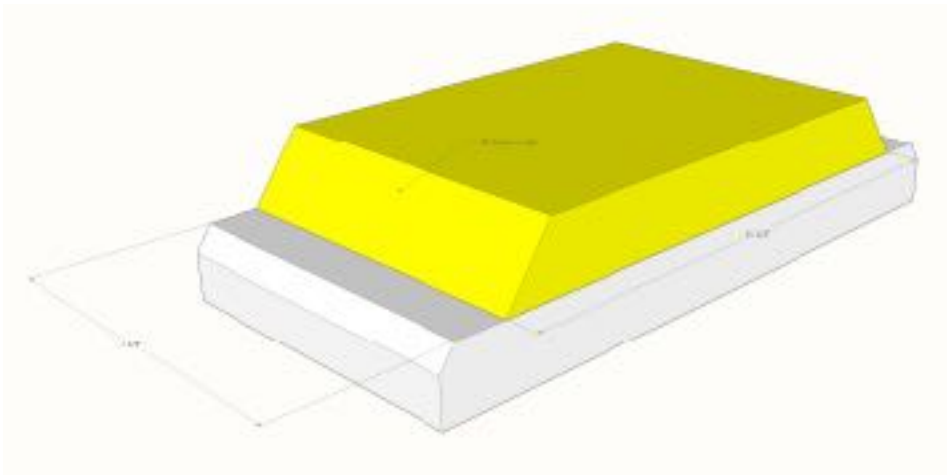

For the second piece, cut a 35 degree angle on the front and back edge. Glue and attach to the top piece with 2 1/2" wood screws, driving the screws from the bottom piece up.

STEP 3:

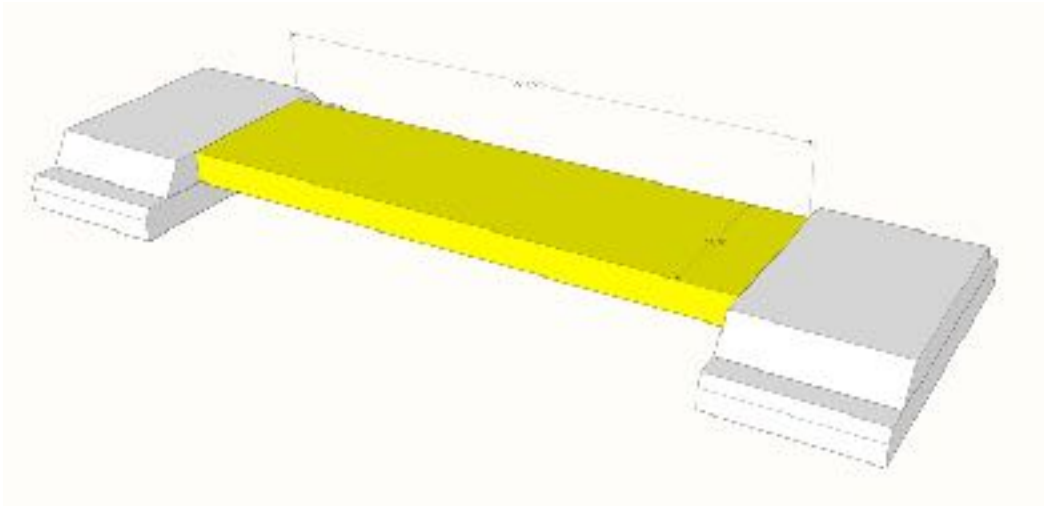

Drill 1/2" pocket holes into each end of the stretcher. Attach to the feet with 2 1/2" pocket screws and wood glue.

STEP 4:

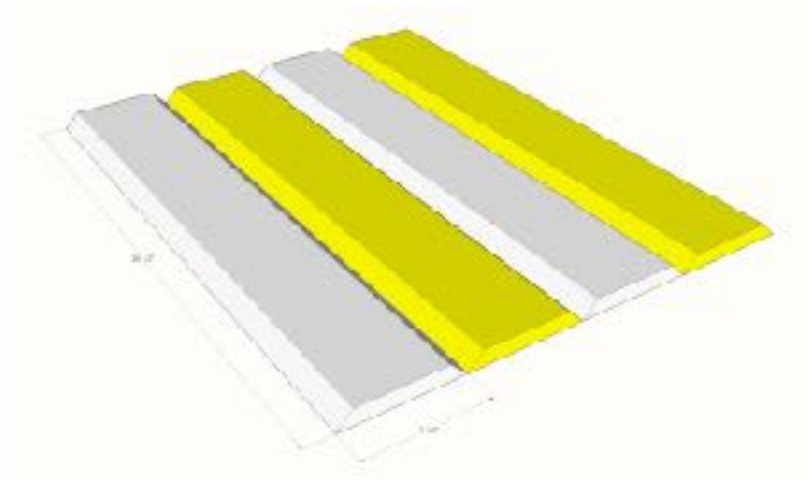

For the legs, cut the 1x6 pieces to 28 1/2". On a table saw, set the blade to cut at 45 degrees and the fence to cut only the 45 degree corner off of the edge, maintaining as much of the width of the board as possible.

STEP 5:

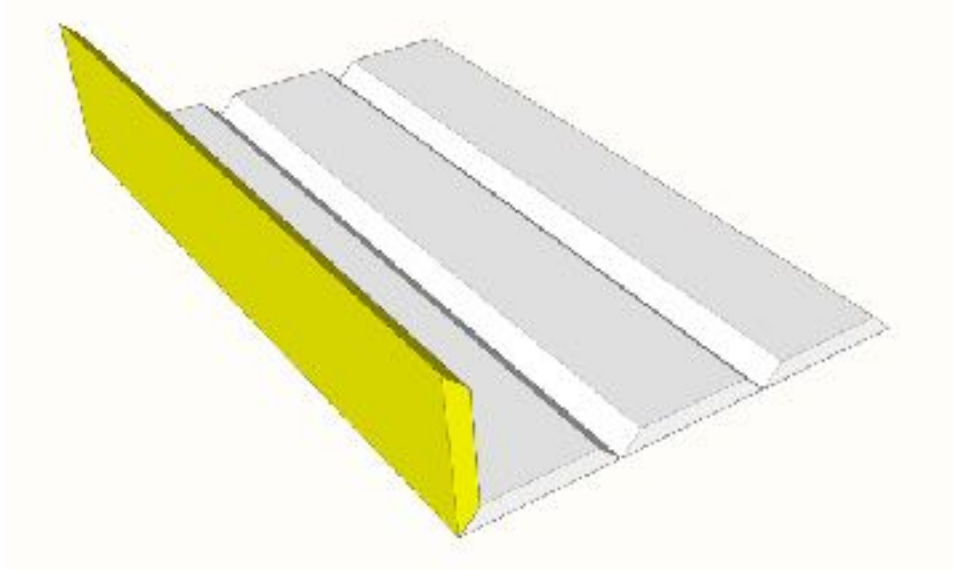

Lay 2-3 long strips of masking tape onto your work surface, sticky side up. Line the boards up side by side over the masking tape. Apply wood glue to the 45 degree joints on each of the boards. Carefully begin folding the boards together to make a box leg.

STEP 6:

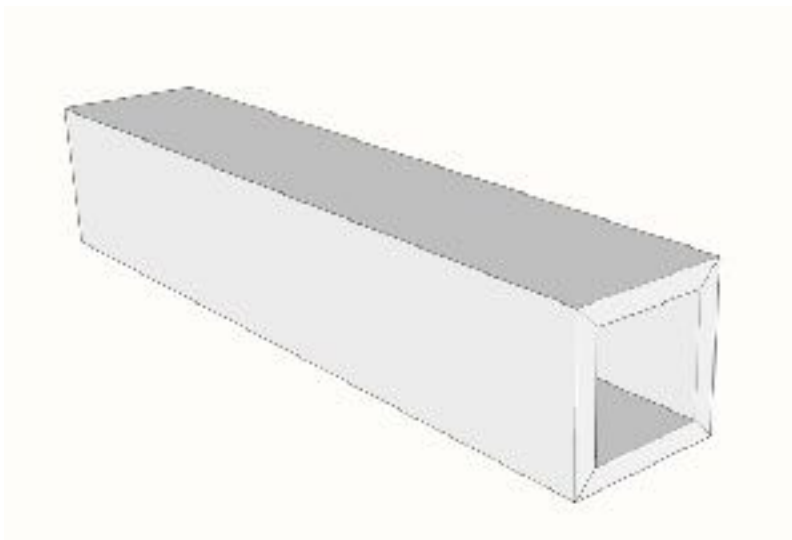

Tape the post together to hold the joints, then nail 1 1/4" brad nails along each joint to secure the leg pieces together. Remove the tape.

STEP 7:

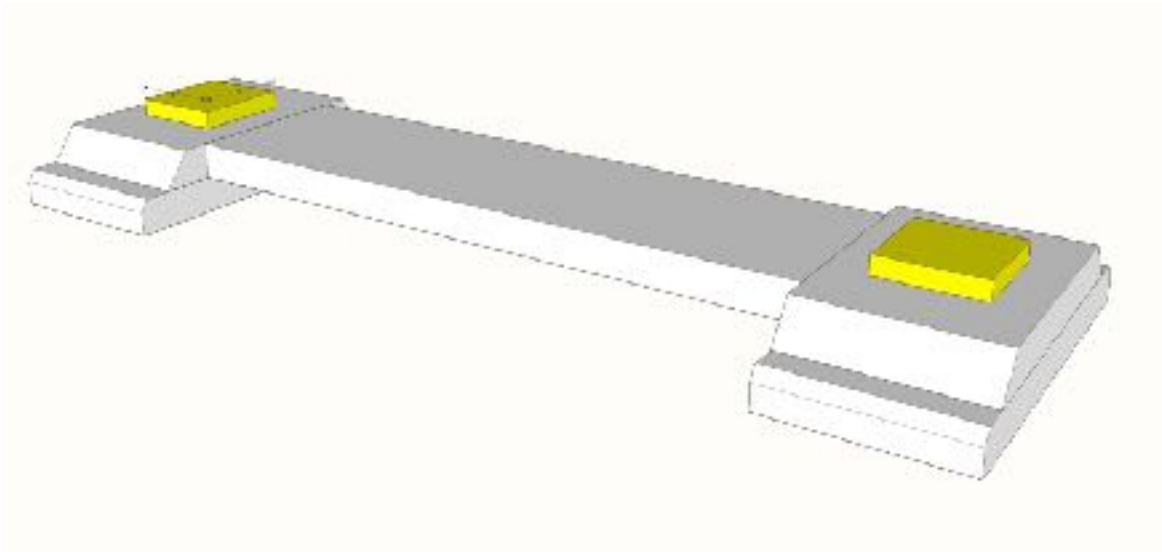

Measure the inside dimensions of the box legs and cut scrap 1x6 pieces to those dimensions (about 4"). Center the blocks over the feet of the table where you want to stand the legs up. Glue and nail into place with 1 1/4" brad nails.

STEP 8:

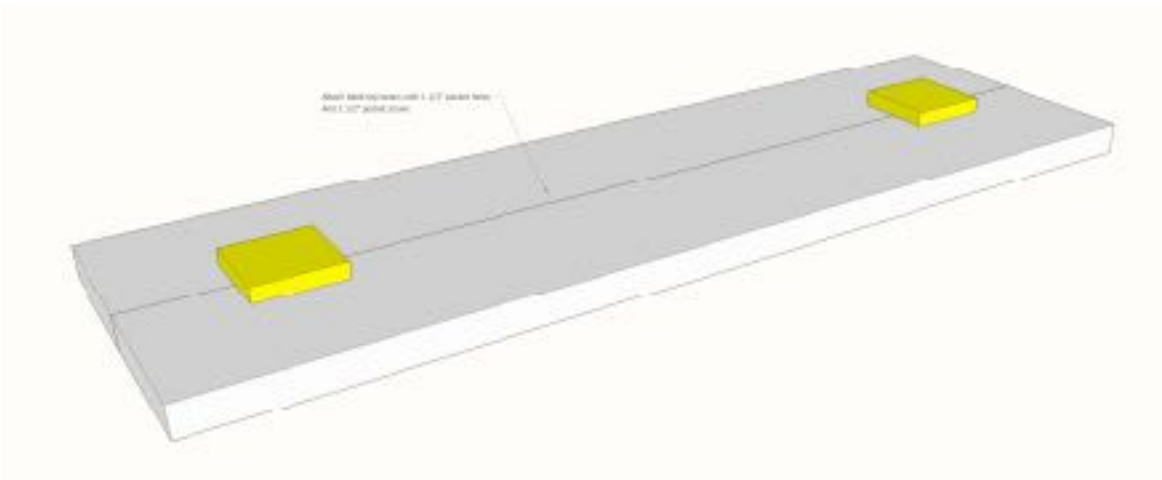

For the table top, drill 1 1/2" pocket holes into the inside edges and attach with wood glue and 2 1/2" pocket screws. Follow the same steps with the blocks for the table top, making sure that it is aligned to give an even overhang over the table when assembled. The easiest way to do this is to dry fit the box legs onto the base and center the table top over it. Mark where the legs will go, then mark 3/4" in from those marks to determine where the blocks will be attached. Glue and nail into place with 1 1/4" brad nails.

STEP 9:

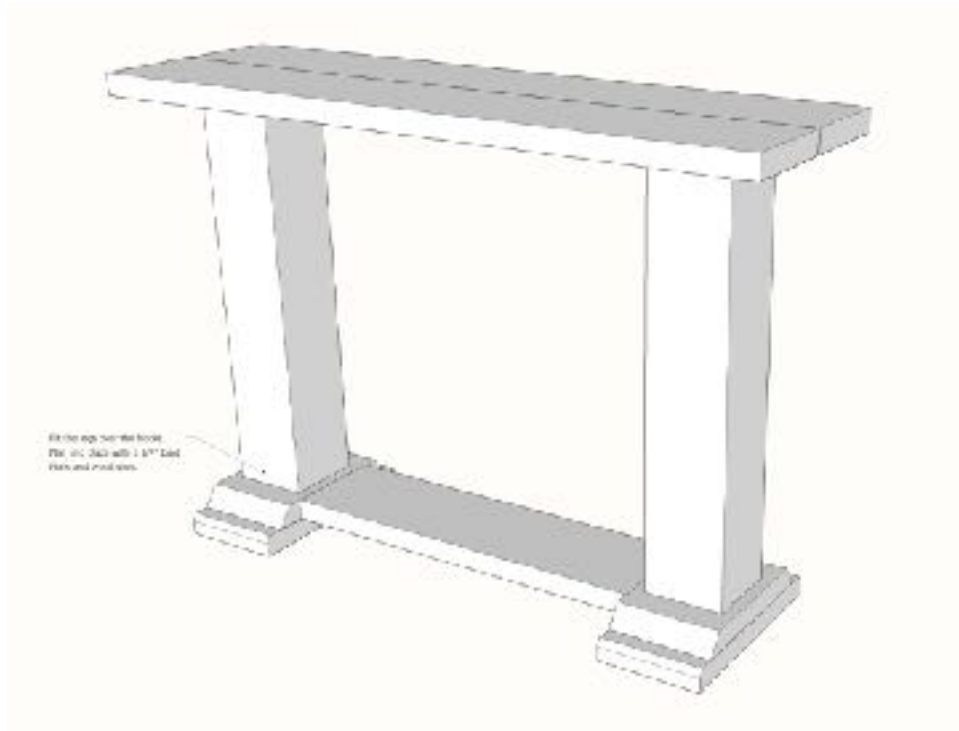

Apply glue to the top and bottom inside edges of the box legs and fit over the blocks on the base and set the top onto the legs. Attach in place with 1 1/4" brad nails, making sure that the nails are driven into the blocks.

Sand and finish as desired. We used Minwax stain in golden oak.

